

Pos. Nr. Pos. no.	Beschreibung Description	Art.-Nr. Art. no.	Preisgruppe Price bracket
1	LOKGEHÄUSE KPL. Body assembly complete	10436001	34
2	FÜHRERHAUSDACH VORMONT. LACK. Roof of driver's cab assy , painted	11436001	14
3	UMLAUFBLECH Running board	114360011	21
4	FÜHRERSTAND Driver's cab complete	12436001	---
5	LICHTLEITER -SATZ Light conductor set	13436001	12
6	FENSTERBLENDEN-SATZ Window set	14436001	11
7	STIRNFENSTER, SCHEIBENWISCHER- Windshield wiper set	144360011	11
8	BESCHWERUNG Ballast	16436001	7
9	ISOLATOREN-SATZ Set of isolators	18436001	12
10	DACHLEITUNG-ÜBERSCHLAGRAHMEN Roof wiring, flashover frame	184360011	12
11	SCHUTZBLECHSATZ Mudguard set	19436001	11
	KLEINTEILE-SATZ (o. Abb.) Set of small parts (w/o illustr.)	194360011	11
13	PFEIFE Whistle	00194617	2
14	KUPPLUNGSHAKEN Coupling hook	00194824	2
	KLEINTEILESATZ FÜR GEHÄUSE (o. Abb.) Set of small parts for body (w/o illustr.)	19492700	14
16	TRITT-SATZ Treadle set	19503500	14
17	GLOCKE, DACHLAUFBRETT Bell, roof running board	19503600	9
18	SCHALTRAD Switch-wheel	19503700	3
19	SIGNALSTÜTZE Signal support	19503800	2
20	LOKLATERNE Loco lamp	19503900	9
21	FAHRGESTELL Chassis	30436001	---
22	BREMSKUPPLUNG KURZ/LANG -SATZ Brake coupling short/long - set	31436001	---
23	BREMSEGEHÄNGE Brake rigging	314360011	---
24	KUKU-DEICHSEL VORNE Short coupling reception front side	00384028	7
25	KUKU-DEICHSEL Short coupling reception rear side	38403300	6
26	KUPPELSTANGEN -SATZ Short coupling reception rear side	42436001	---
27	DREHGESTELL KPL. Pony truck, complete	47436001	---
28	MOTOR M.SCHW.F.4046 Motor with flywheel	00504046	29
29	KOHLENHALTER Carbon brush holder	00507801	1
30	MOTORHALTEBUEGEL Motor retainer clip	00507903	4
31	TREIBRAD LI Driving wheel, left	51447300	11
	TREIBRAD RE. (o. Abb.) Driving wheel, right (w/o illustr.)	51447400	11
33	KUPPELRAD LINKS Coupled wheel, left	51447500	9
	KUPPELRAD RECHTS (o. Abb.) Coupled wheel, right (w/o illustr.)	51447600	9
35	BLINDWELLENKURBEL Jackshaft crank	51447700	8
	BLINDWELLENKURBEL RECHTS (o. Abb.) Jackshaft crank (w/o illustr.)	51447800	8
37	ACHSE Axle	00527008	1

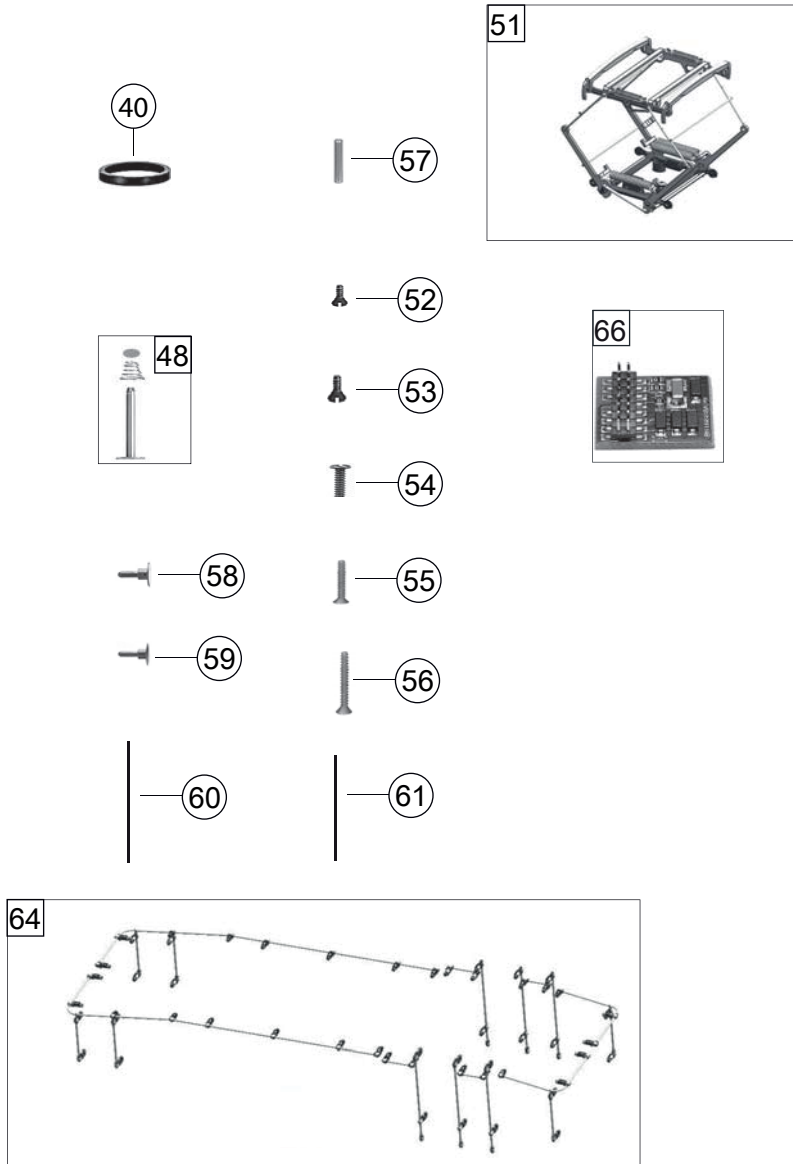

436001		BR E60 DRG	E 6008	=	HO
Pos. Nr. Pos. no.	Beschreibung Description	Art.-Nr. Art. no.	Preisgruppe Price bracket		
38	ACHSE Axle	00524011	1		
39	LAUFRADSATZ KPL. Carrying wheelset, complete	53432400	---		
40	HAFTREIFEN H0 Traction tyre H0	00544006	1		
41	ZAHNRAD M. RATSCHRING Z:28 Gear wheel with ratchet ring Z=28	00564178	5		
	UNTERSETZUNGSRAD Z:18/24 (o. Abb.) Reduction gear wheel Z:18/24 (w/o illustr.)	00564179	6		
	ZAHNRAD M.FED. F.4046 (o. Abb.) Gear wheel with spring (w/o illustr.)	00564185	5		
44	SCHNECKE D = 4MM L = 7MM Worm gear D = 4MM L = 7MM	00567605	6		
45	ABDECKPLATTE MIT RADKONT Cover plate with wheel contacts	60436001	---		
46	MOTORKONTAKTFEDER LI Motor contact spring, left	61498500	---		
47	MOTORKONTAKTFEDER RE Motor contact spring, right	61498600	---		
48	KONTAKTPILZGARNITUR Contacter pin assy	64441900	---		
49	LEITERPLATTE KPL. PCB, complete	65418300	---		
50	LEITERPLATTE PCB	65418400	---		
51	DACHSTROMABNEHMER Pantograph	67433800	18		
52	Senkschraube M1,6x4 DIN7500 RO Countersunk screw M 1.6 X 4 DIN7500	70900007	2		
53	SK-Schraube M2x5 DIN7500 EK/SW Countersunk screw M 2 X 5 DIN7500, black	70900009	1		
54	GF-Schraube M2x5 DIN7500 SW Self-cutting screw M2x5 DIN7500, black	70900011	3		
55	SENKKOPFBLECHSCHRAUBE B 2,2 x Countersunk tapping screw B 2.2	70900030	3		
56	SENKKOPFBLECHSCHRAUBE KREUZSCH Countersunk philipps screw	00712509	1		
57	ZYLINDERSTIFT 2 X 10 Cylinder pin 2x10	00730538	1		
58	STECKPUFFER Plug-in buffer, curved	00754006	2		
59	STECK-PUFFER FLACH Plug-in buffer, flat	00754015	2		
60	RICHTFEDER Straightening spring	00764020	2		
61	RICHTFEDER F.4122 Straightening spring F.4122	00764021	2		
62	ANDRUCKFEDER F.RADSATZ Pressure spring for wheelset	00764328	1		
63	DEICHELFEDE Pony truck spring	76433800	3		
64	GRIFSTANGENSATZ Hand-rail -set	19492600	14		
65	LICHTKONTAKT Light contact	61498700	---		
66	PLUX-Brückenstecker Plux jumper	66401500	17		
	STECKKUPPLUNG (o. Abb.) Clip-in coupling (w/o illustration)	6510	---		
	STECK-TAUSCHKUPPLUNG (o. Abb.) Clip-in standard coupling (w/o illustration)	6511	---		
	PROFI-STECKKUPPLUNG (o. Abb.) Profi plug-in coupling (w/o illustr.)	6515	---		
	ERSATZ-SCHLEIFKOHLEN (o. Abb.) Carbon brushes set (w/o illustr.)	6518	---		

Symbolische Darstellung
Symbolic illustration