

398677 BR 86 ÖBB		86 452	~	🔊	H0
Pos. Nr. Pos.no.	Beschreibung Description	Art.-Nr. Art.no.	Preisgruppe Price bracket		
1	LOKGEHÄUSE KPL. Body assembly complete	10408677	---		
2	LICHTLEITER-SATZ Light conductor set	00134087	9		
3	AUFSTIEGSTRIIT -SATZ Set of ladders	15408677	---		
4	GRIFFSTANGE ROT Hand-rail -set, red	19473400	2		
5	KUPPLUNGSHAKEN (o.Abb.) Coupling hook (w/o illustration)	00194824	2		
6	LEITER TENDERSEITE Rear ladder	00194832	2		
7	SCHIENENRAEUMER Rail guard	22408603	7		
	STECKKUPPLUNG (200ST.) BÜGELK (o. Abb.) Standard plug-in coupling (set of 200) (w/o illust.)	00386511	41		
9	LOKFAHRGESTELL KPL. Chassis complete	40398677	---		
8	LOKFAHRGESTELL MIT MOTOR Chassis complete with motor	41398677	---		
10	STEUERUNG NEU BR 86 Reversing gear complete (new)	42408671	31		
11	ZYLINDERKASTEN - SATZ Cylinder box	00434086	12		
12	RAUCHKAMMERTRAEGER Smoke box support	00454087	14		
14	DEICHELFOHRUNG VORN Front framework	47408603	18		
13	DREHGESTELL KPL.(Speichenräder Bogie complete (spoked wheels)	47398677	---		
13a	DREHGESTELL KPL.(Scheibenräder Bogie complete (disc type wheels)	473986771	---		
15	DEICHELFOHRUNG HINTEN Rear framework	49408603	18		
16	ANKER KPL.M.SCHWUNGMASSE Rotor complete with integr. flywheel	00504607	25		
17	LAGERSCHILD KPL. Motor PCB insulated	50474300	18		
18	KOEHLENROHRKAPPE Brush pipe cap	00504801	2		
19	LOKRAD GR.GEGENGEW. Loco wheel (big counterweight)	00514322	8		
20	TREIBRAD RECHTS ISOLF BR 86 Right driving wheel, insulated	00514323	9		
21	LOKRAD KL.GEGENGEW. Loco wheel (small counterweight)	00514324	8		
23	KUPPELRAD LINKS M.N.F. BR 86 Left coupled wheel with traction tyre	00514326	8		
25	ACHSE 10 MM Axle 10mm	00524002	2		
26	ACHSE GERAENDELT 20 MM Milled axle 20mm	00524006	2		
27	ACHSE Axle	00524008	5		
28	SCHIEBENRADSATZ KPL. Carrying wheelsset complete (disc type wheels)	53428700	---		
28a	RADSATZ KPL. Carrying wheelsset complete (spoked wheels)	53428800	---		
29	HAFTREIFEN H0 Traction tyre H0	00544006	1		
30	ZAHNRAD Z:23 MS Brass gear wheel Z:23	00564155	8		
31	UNTERSETZUNGSRAD Z:24/12 BR 86 Reduction gear wheel Z:24/12	00564156	6		
32	UNTERSETZUNGSRAD Z:24/12 SCHWA Reduction gear wheel Z:24/12, black	00564157	6		
33	UNTERSETZUNGSRAD Z:32/25 SCHWA Reduction gear wheel Z:32/25, black	00564158	6		
34	RITZEL Z:9 Gear wheel Z:9	00564608	7		

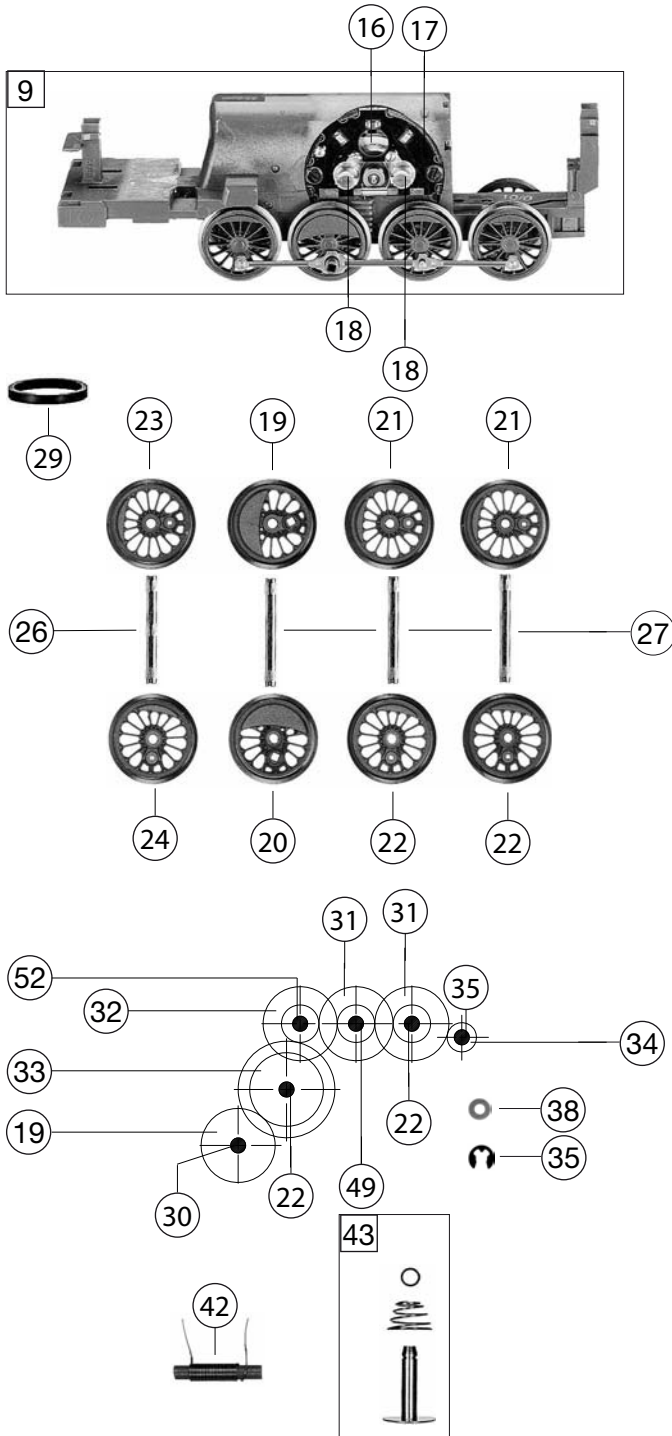

398677 BR 86 ÖBB		86 452	~	🔊	HO
Pos. Nr. Pos.no.	Beschreibung Description	Art.-Nr. Art.no.	Preisgruppe Price bracket		
35	SICHERUNGSRING Securing ring	00564704	1		
	UNTERLEGSCH. ROT 2,3 X 5 X 0,1 (o.Abb.) Washer for rotor (w/o illustration)	00564747	1		
	UNTERLEGSCH. ROT 2,2X5X0,3 (o.Abb.) Washer for rotor, red (w/o illustration)	00564751	1		
38	UNTERLEGSCH. ROT Washer	00564753	1		
39	DISTANZRING f. Steuerung (o.Abb.) Spacer ring for reversing gear (w/o illustration)	00564775	2		
40	STROMABNEHMEREINS.BR 86 SCHN.S Power pick-up assembly	60408603	16		
	KLEMMSTUECK f. Schleifer (o.Abb.) Fixation for center pick-up (w/o illustration)	00621002	9		
	KONTAKTBLECH f. Schleifer (o.Abb.) Contact sheet for center pick-up (w/o illustration)	00621003	6		
61	GLÜHLAMPE Replacement bulb clear with plug-in socket	00621337	8		
	HALTEPLATTE (o.Abb.) Fixation plate (w/o illustration)	62408671	12		
41	LAMPENKONTAKTHALTER Lamp support complete	63398677	---		
	LAUTSPRECHER Ø 23 mm 8 Ohm (o.Abb.) Loudspeaker (w/o illustration)	68400300	16		
	SOUND-DECODER (o.Abb.) Sound decoder (w/o illustration)	68398677	---		
	SKI-SCHLEIFER (o.Abb.) Center pick-up (w/o illustration)	00692021	13		
46	SCHRAUBE Screw	00700313	1		
47	SCHRAUBE Screw	00700404	1		
48	SCHRAUBE F.GEHAEUSE Body fixation screw	00712516	1		
49	ZYLINDERSTIFT F. ZAHNRAD Cylinder pin for gear wheel	00730519	2		
52	BOLZEN F. ZAHNRAD Bolt for gear wheel	00730547	2		
50	GESTÄNGEBOLZEN SCHW.VERN. Linkage pin; nickel-plated, black	00730553	2		
51	GEST.BOLZEN F.4.RS BR 41 Linkage pin for 4th wheelset	00730554	2		
53	Steckpuffer gewölbt Plug-in buffer, curved	00754006	2		
54	STECK-PUFFER FLACH Plug-in buffer, flat	00754015	2		
	DRAHTRICHTFEDER L=27 MM (o. Abb.) Thread straightening spring L=27mm (w/o illust.)	00764016	2		
56	ANDRUCKFEDER F.RADSATZ 4086 Pressure spring for wheelset	00764316	1		
	FLEISCHMANN KUPPLUNG Fleischmann coupling	6510	---		
	STECK-TAUSCHKUPPLUNG Standard coupling	6511	---		
	PROFI-STECKKUPPLUNG Profi coupling	6515	---		
	ERSATZ-SCHLEIFKOHLEN Carbon brushes set	6519	---		