

Pos. Nr. Pos.no.	Beschreibung Description	Art.-Nr. Art.no.	Preisgruppe Price bracket
1	LOKGEHÄUSE KPL. Body assembly complete	10409201	038
2	LICHTLEITER U.LATERNEN S. Light conductor&lamp set	00134095	015
3	PFEIFE Whistle	00194607	004
4	KUPPLUNGSHAKEN (o.Abb.) Coupling hook (w/o illustration)	00194824	002
5	SCHEIBEN MAGNET F.BR 94 Disc magnet	00195005	006
6	KU-KU DEICHSEL-SATZ F.BR 94 Short coupling reception -set	00384026	009
7	DEICHSELABSTÜTZUNG-SATZ BR 94 Short coupling reception cover -set	00384027	009
8	FAHRGESTELL KPL.M.SS Chassis complete with interface	00404096	049
9	LOKFAHRGEST.M.GETR.U.RAED. Loco chassis with gearset and wheels	00414096	040
10	STEUERUNG KPL.F.BR 94 Reversing gear complete	00424096	034
11	ZYLINDERKASTEN F.BR 94 Cylinder box	00434096	011
12	LICHTABDECKUNG F.BR 94 Light cover	00454096	006
13	ANKER KPL.M.SCHWUNGMASSE Rotor complete with integr. flywheel	00504607	025
14	LAGERSCHILD ISOLIERT Motor PCB insulated	00504732	017
15	KOHLENROHRKAPPE Brush pipe cap	00504801	002
16	TREIBRAD O.Z.O.N.ROT Driving wheel, w/o gear wheel, w/o trac. tyre, red	00514165	007
17	TREIBRAD O.Z.O.N.ISO ROT Driving wheel, w/o gear wheel, w/o trac. tyre, insul.,red	00514166	008
18	KUPPELRAD O.Z.O.N.ROT Coupled wheel w/o traction tyre, w/o gear wheel, red	00514167	007
19	KUPPELRAD O.Z.O.N.ISO.ROT Coupled wheel w/o traction tyre, w/o gear wheel, red	00514168	008
20	KUPPELRAD O.Z.M.N.ROT Coupled wheel with traction tyre, w/o gear wheel, red	00514376	009
21	KUPPELRAD O.Z.M.N.ROT ISO. Coupled wheel with tract. tyre, w/o gear wheel, insul.,red	00514377	011
22	ACHSE 10 MM Axle 10mm	00524002	002
23	ACHSE Axle	00524011	001
24	HAFTREIFEN H0 Traction tyre H0	00544006	001
25	UNTERSETZUNGSRAD Z:28/13 SCHWA Reduction gear wheel Z:28/13, black	00564102	002
26	UNTERSETZUNGSRAD Z:33/14 SCWA Reduction gear wheel Z:33/14, black	00564115	002
27	ZAHNRAD Z:18 SCHWARZ Gear wheel Z:18, black	00564120	003
28	MESSINGZAHNRAD Z:18 Brass gear wheel Z:18	00564133	007
29	RITZEL Z:10 Gear wheel Z:10	00564602	004
30	SICHERUNGSRING KLEIN Securing ring, small	00564701	001
31	UNTERLEGSCH. ROT 2,2X5X0,5 (o.Abb.) Washer, red, 2.2X5X0.5 (gear side) (w/o illustr.)	00564742	001
32	UNTERLEGSCH. 2,3 X 5 X 0,1 Washer 2.3X5X0.1 (collector side)	00564747	001
33	UNTERLEGSCH.ROT 2,2X5X0,3 (o.Abb.) Washer, red, 2.2X5X0.3 (gear side) (w/o illustr.)	00564751	001
34	STROMABNEHMEREINSATZ Power pick-up assembly	00604096	018
35	KONTAKTFEDER LINKS F.BR 94 Contacter sheet, left side	00614920	006

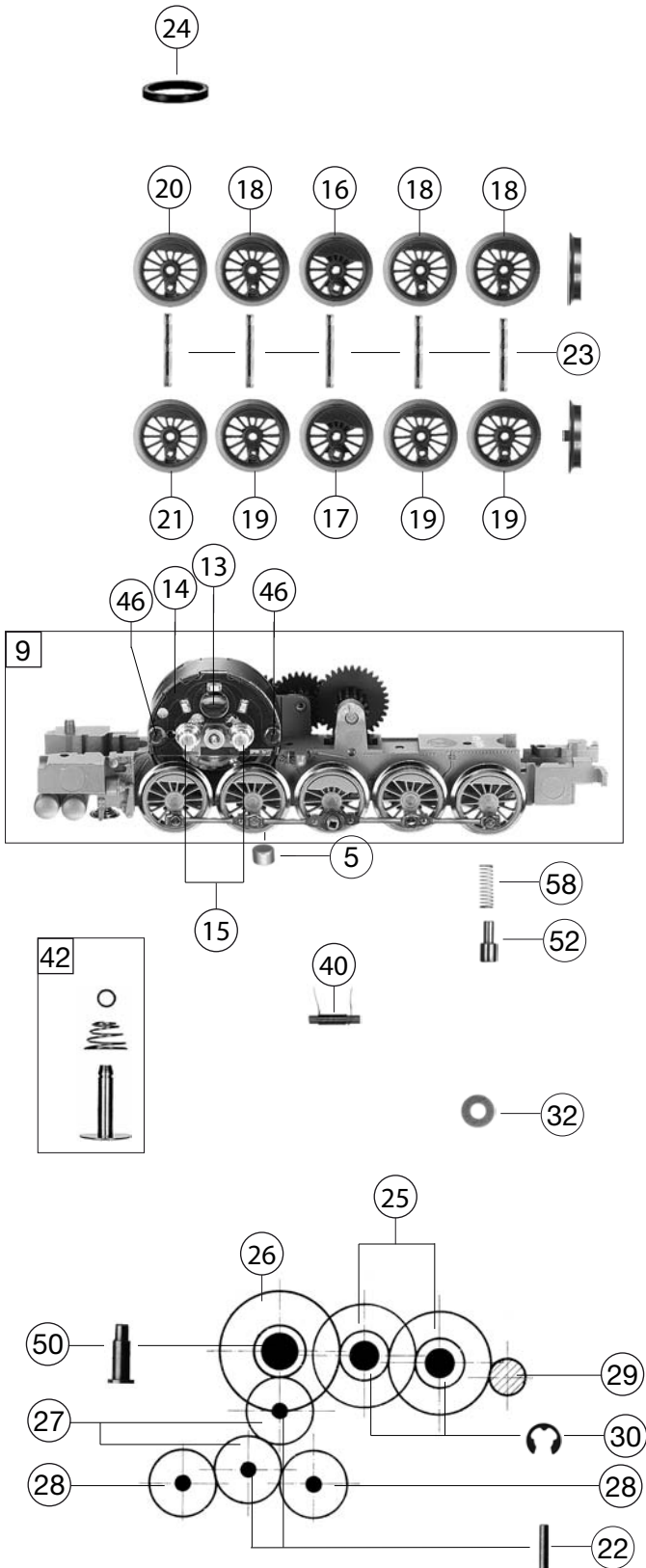

409201		BR 94.5 DR	941346-9	=	HO
Pos. Nr. Pos.no.	Beschreibung Description		Art.-Nr. Art.no.	Preisgruppe Price bracket	
36	KONTAKTFEDER RECHTS F.BR 94 Contacter sheet, right side		00614921	006	
37	ABDECKBLECH M.FASSUNG HINTEN Cover sheet with lamp socket (rear)		00624096	012	
38	ABDECKBLECH M.FASSUNG VORNE Cover sheet with lamp socket (front)		06240961	011	
39	HALTEPLATTE Mounting plate		00627170	002	
40	ENTSTOERDROSSEL Suppressor choke		00644101	007	
41	ENTSTOERDROSSEL(MAERKLIN) Suppressor choke (MAERKLIN)		00644102	005	
42	KONTAKTPILZGARN.F. BR 94 Contacter pin assembly		00644412	011	
43	BUCHSENLEISTE 6-POL.F.SCHNITT. Connector interface, 6-pin		00654073	014	
44	SCHNITTST.-BLINDSTECKER 6-POL. Jumper, 6-pin		00664002	013	
45	SCHRAUBE M 1,4 X 3 Screw M 1.4 X 3		00700203	001	
46	SCHRAUBE Screw		00700313	001	
47	SCHRAUBE Screw		00700405	001	
48	SCHRAUBE Screw		00700410	001	
49	SCHRAUBE Screw		00713516	001	
50	BOLZEN F. ZAHNRAD Cylinder pin for gear wheel		00730509	004	
51	BOLZEN F.KUPPELSTANGE Bolt for coupling rod		00730569	001	
52	LAGERBOLZEN Bearing bolt		00730571	002	
53	BOLZEN F.KUPPELSTANGE Bolt for coupling rod		00730572	002	
54	Steckpuffer Plug-in buffer, curved		00754006	002	
55	STECK-PUFFER FLACH Plug-in buffer, flat		00754015	002	
56	DRAHTRICHTFEDER Thread straightening spring		00764023	002	
57	DRAHTRICHTFEDER L=15 MM Thread straightening spring, L=15mm		00764024	002	
58	DRUCKFEDER Pressure spring		00764332	002	
	FLEISCHMANN KUPPLUNG Fleischmann coupling		6510	---	
	STECK-TAUSCHKUPPLUNG Standard coupling		6511	---	
	PROFI-STECKKUPPLUNG Profi coupling		6515	---	
	ERSATZ-SCHLEIFKOHLEN Carbon brushes set		6519	---	
63	ERS.-GLÜHLAMPE M.SCHRAUBFAS. Screw-type bulb		00006530	007	